

NO.	REVISION	DATE
1	ADDENDUM #1	6/25/19
2		
3		
4		
5		

SHEET TITLE	PROJECT TITLE
COVER SHEET	TUNSTALL-BROSVILLE (HWY 622) COLLECTION CENTER

CLIENT
PITTSYLVANIA COUNTY 1 CENTER STREET CHATHAM, VA 24531

SCS ENGINEERS	DATE	SCALE
STEARN, CONRAD AND SCHMIDT CONSULTING ENGINEERS, INC. 2877 GUARDIAN LANE, VIRGINIA BEACH, VA 23462 PH. (757) 466-3361 FAX. (757) 267-8349	JUNE 2019	AS SHOWN

DRAWING NO.
1 of 5

PITTSYLVANIA COUNTY TUNSTALL-BROSVILLE (622) COLLECTION CENTER RE-DEVELOPMENT

REVISED ⚠



INDEX OF DRAWINGS

NO.	TITLE
1.	COVER SHEET
2.	EXISTING CONDITIONS
3.	SITE PLAN-REVISED ⚠
4.	DETAILS-1 AND GENERAL NOTES
5.	DETAILS-2 -REVISED ⚠

LEGEND:

	EXISTING CONTOUR MINOR (2' INTERVAL)
	EXISTING CONTOUR MAJOR (10' INTERVAL)
	EXISTING ROAD
	EXISTING FENCE
	EXISTING TREELINE
	EXISTING PROPERTY LINE
	EXISTING RIGHT OF WAY/ADJACENT PROPERTY LINES
	EXISTING SANITARY SEWER CLEANOUT
	EXISTING OVERHEAD ELECTRICAL WIRES
	EXISTING ELECTRIC EASEMENT
	EXISTING UTILITY POLE
	EXISTING RIP RAP/ROCKS
	EXISTING UNDERGROUND TELEPHONE
	PROPOSED CONTOUR MINOR (2' INTERVAL)
	PROPOSED CONTOUR MAJOR (10' INTERVAL)
	PROPOSED TREE LINE
	PROPOSED IMPERVIOUS COVER
	PROPOSED EDGE OF ASPHALT
	PROPOSED 6" DASHED VDOT TYPE A WHITE PAINT
	PROPOSED 6" SOLID VDOT TYPE A YELLOW OR WHITE PAINT
	PROPOSED SIDE SLOPE GABION STONE
	PROPOSED GRAVEL PAD
	PROPOSED SEALCOAT AREA
	PROPOSED ASPHALT AREA

PREPARED FOR
PITTSYLVANIA COUNTY
1 CENTER STREET
CHATHAM, VA 2431

TUNSTALL-BROSVILLE (HWY 622)
COLLECTION CENTER
95 CASCADE RD
CASCADE, VA 24609

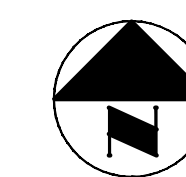

LOCATION MAP
SCALE: NTS

PREPARED BY

SCS ENGINEERS

2877 GUARDIAN LANE, SUITE 1-F
VIRGINIA BEACH, VA 23452
(757) 466-3361

JUNE 25, 2019 ⚠

GENERAL NOTES:

1. ALL CONSTRUCTION METHODS AND MATERIALS WILL CONFORM TO THE PROJECT SPECIFICATIONS AND ANY OTHER APPLICABLE CITY OR STATE ORDINANCES, CODES, AND LAWS.
2. PRIOR TO CONSTRUCTION, THE CONTRACTOR WILL BE RESPONSIBLE FOR LOCATING ALL UNDERGROUND UTILITIES (PUBLIC OR PRIVATE) THAT MAY EXIST AND CROSS THROUGH THE AREA OF CONSTRUCTION. A MINIMUM OF 72 HOURS PRIOR TO EXCAVATING "MISS UTILITY" OF VIRGINIA (1-800-552-7001) MUST BE CONTACTED. THE CONTRACTOR IS RESPONSIBLE FOR REPAIRING ANY EXISTING UTILITIES THAT ARE DAMAGED DURING CONSTRUCTION, AT THEIR OWN EXPENSE.
3. TOPOGRAPHIC INFORMATION ON THIS SHEET WAS COMPILED BY HURT & PROFFITT ON APRIL 24, 2019 UNDER THE DIRECT RESPONSIBLE CHARGE OF JOSEPH M. MAY USING ACTUAL GROUND SURVEY AND MEETS ALL OF THE MINIMUM ACCURACY STANDARDS..
4. HORIZONTAL DATUM VIRGINIA STATE PLANE COORDINATE SYSTEM, SOUTH ZONE, NAD 83 VERTICAL DATUM NAVD 88.
5. A BENCHMARK IS LOCATED IN THE LIGHT POLE BASE NEAR THE FRAME SHED AND CAN BE USED DURING CONSTRUCTION.
6. THE AREA SHOWN HEREON IS LOCATED IN FLOOD HAZARD ZONE 'X' AND IS NOT LOCATED WITHIN FLOOD HAZARD ZONE 'AE' FOR A 100 YEAR FLOOD AS DETERMINED BY THE FEDERAL EMERGENCY MANAGEMENT AGENCY AS SHOWN ON FEMA MAP#51143C0585E DATED SEPTEMBER 29, 2010.
7. GENERAL LEGEND SHOWN ON DRAWING NO. 1-COVER SHEET.

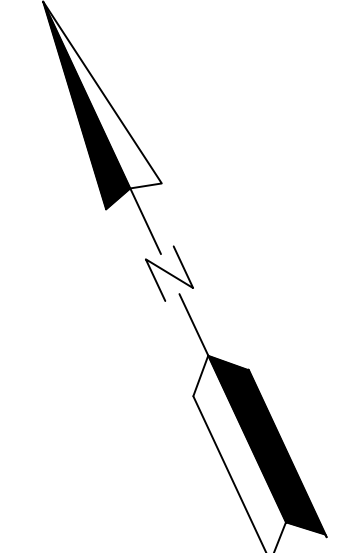
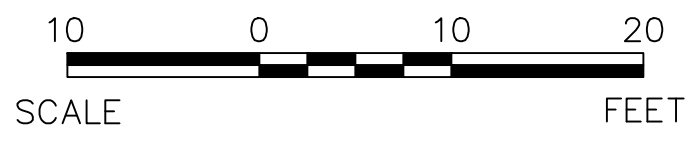

PID #1358-08-9513
SRE, L.L.C.
D.B. 1332 PAGE 44
M.B. 43 SLIDE 324-I

PID #1358-08-7521
1.001 ACRES

PID #1358-08-7268
TRUDI LYNN MCDANIEL
D.B. 685 PAGE 582
D.B. 685 PAGE 584 (PLAT)

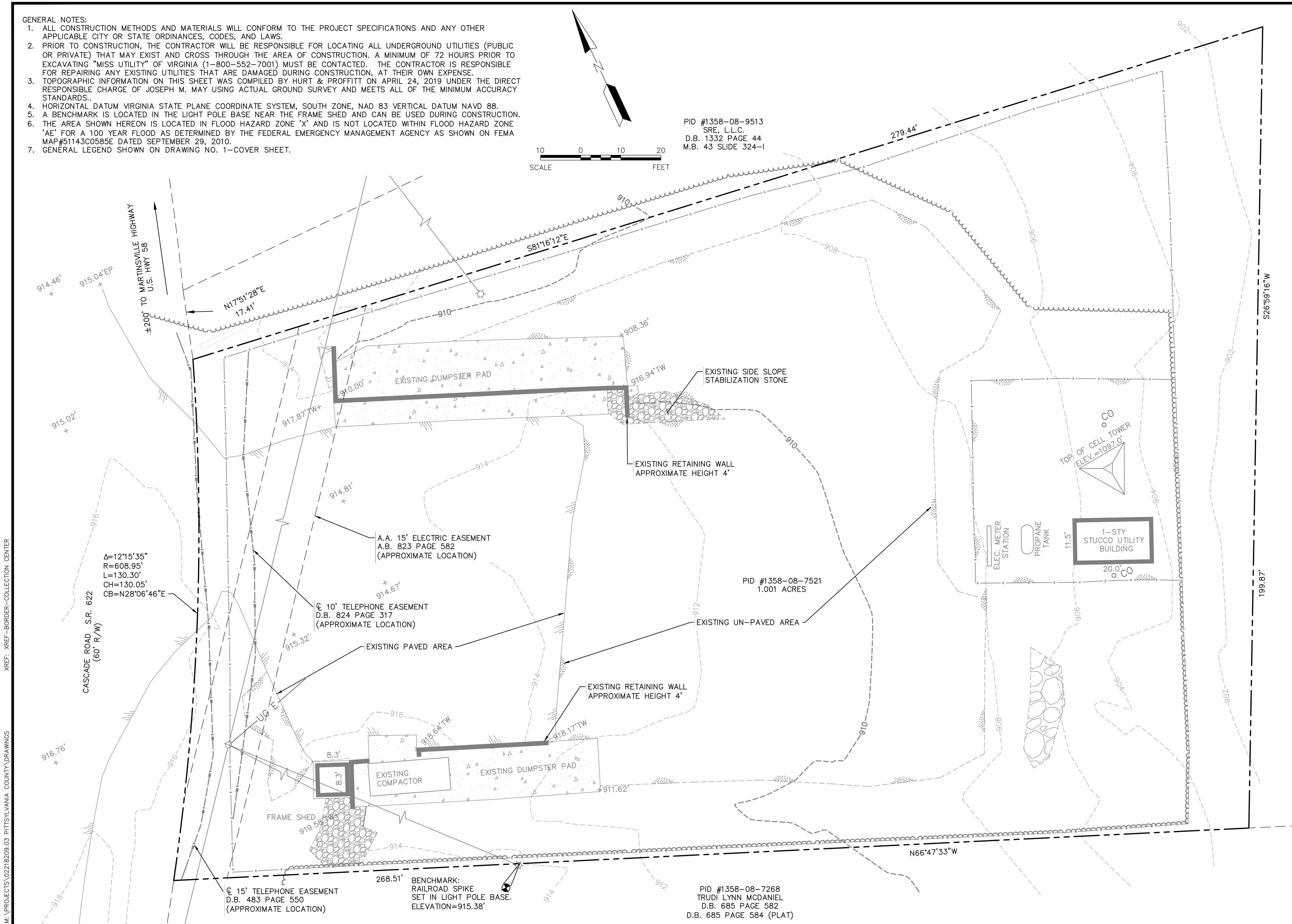

M:\PROJECTS\02218209.03 PITTSYLVANIA COUNTY DRAWINGS XREF: XREF-BORDER-COLLECTION CENTER

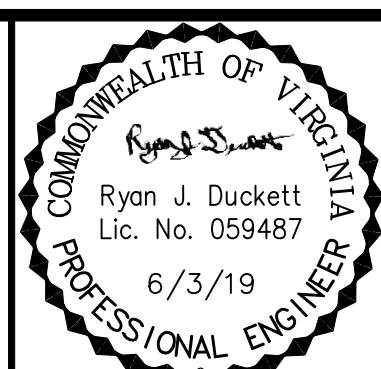

NO.	REVISION	DATE

SHEET TITLE: EXISTING CONDITIONS
PROJECT TITLE: TUNSTALL-BROSVILLE (HWY 622) COLLECTION CENTER

CLIENT: PITTSYLVANIA COUNTY
1 CENTER STREET
CHATHAM, VA 24531

SCS ENGINEERS
STEARNS, CONRAD AND SCHMIDT
CONSULTING ENGINEERS, INC.
2877 GUARDIAN LANE, VIRGINIA BEACH, VA 23462
PH. (757) 466-3361 FAX. (757) 257-5349

PROJ. NO. 02218209.03
DATE: 02/21/2019
DRAWN BY: NTJ
CHECKED BY: GSW
APP. BY: RSD
DES. BY: RSD

CADD FILE: SHT2-EXISTING
DATE: JUNE 2019
SCALE: AS SHOWN

DRAWING NO. 2 of 5

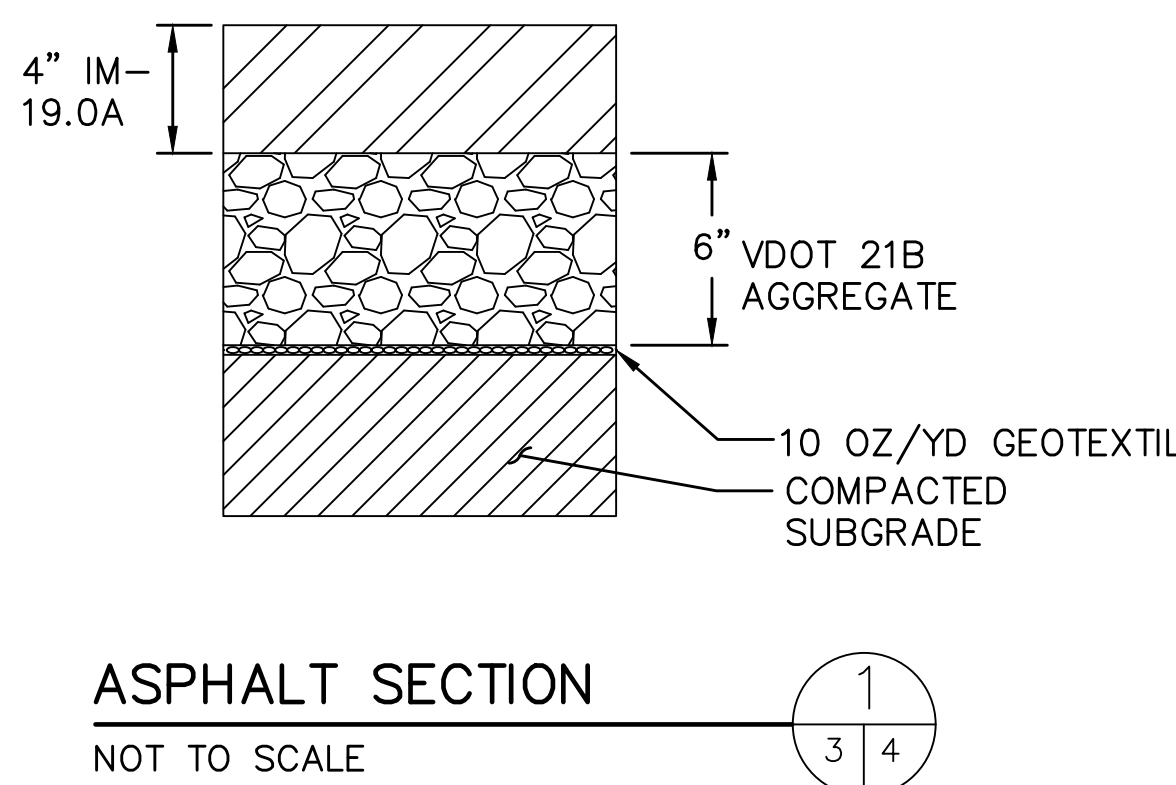
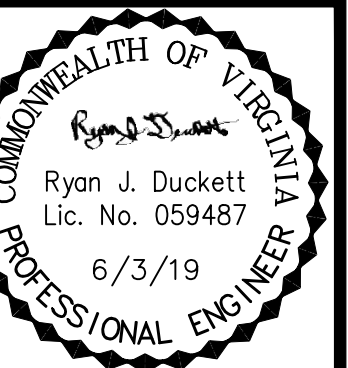

ASPHALT SECTION
NOT TO SCALE

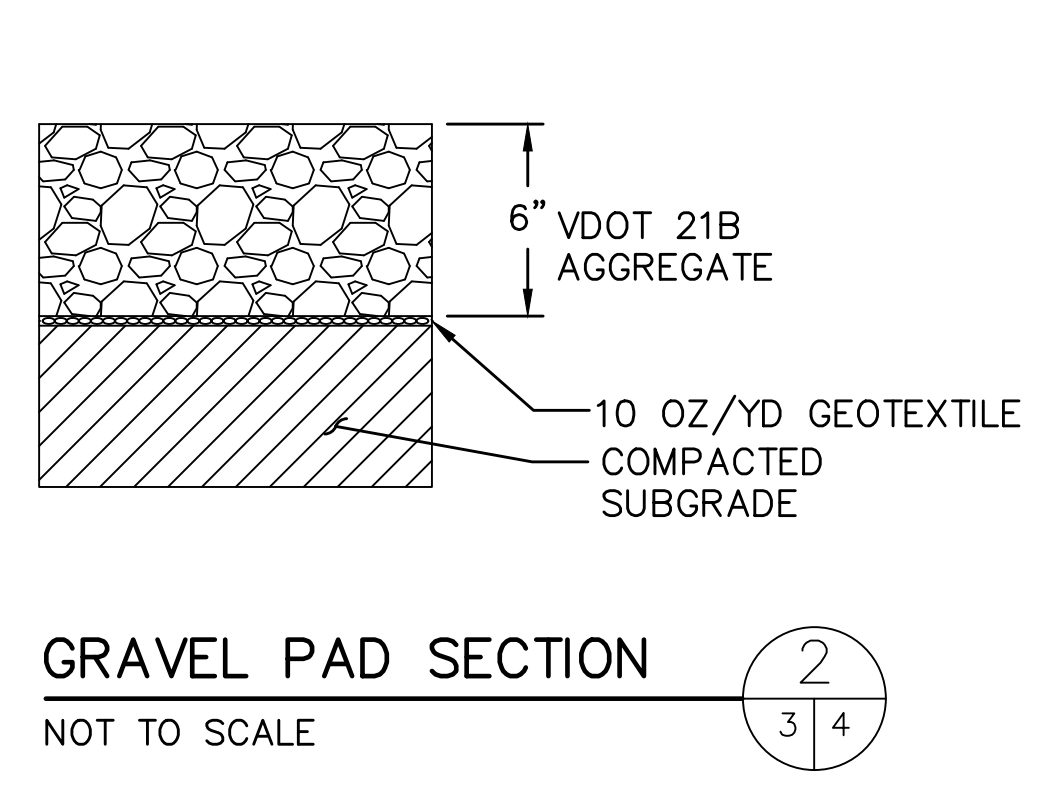

GRAVEL PAD SECTION
NOT TO SCALE

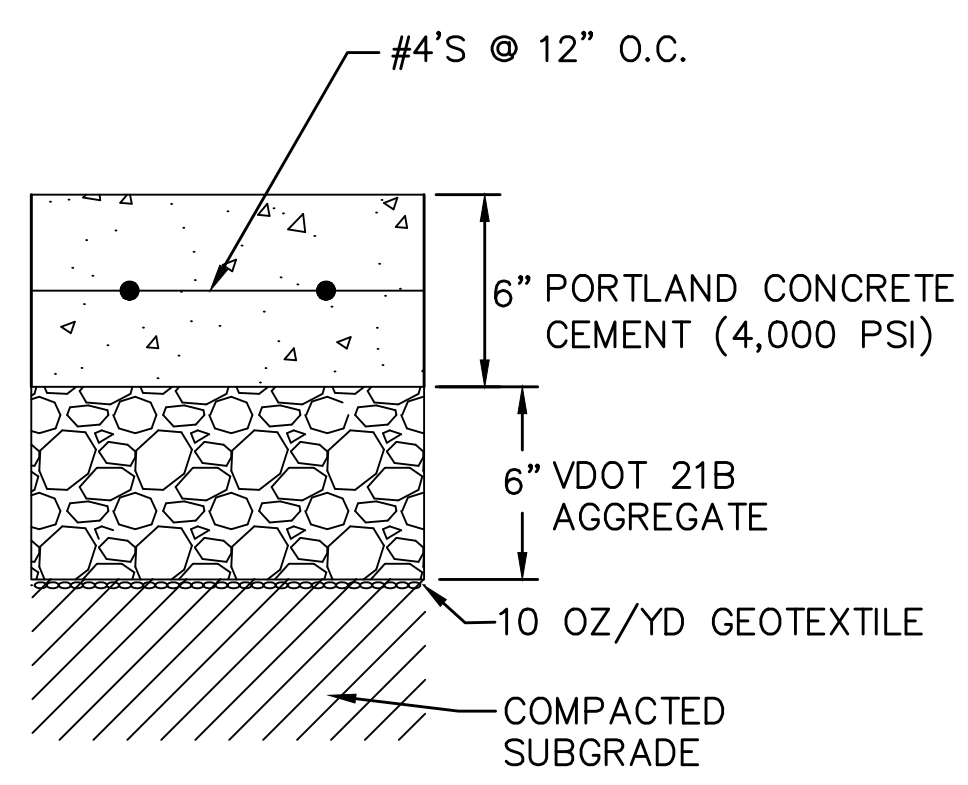

CONCRETE PAD SECTION
NOT TO SCALE

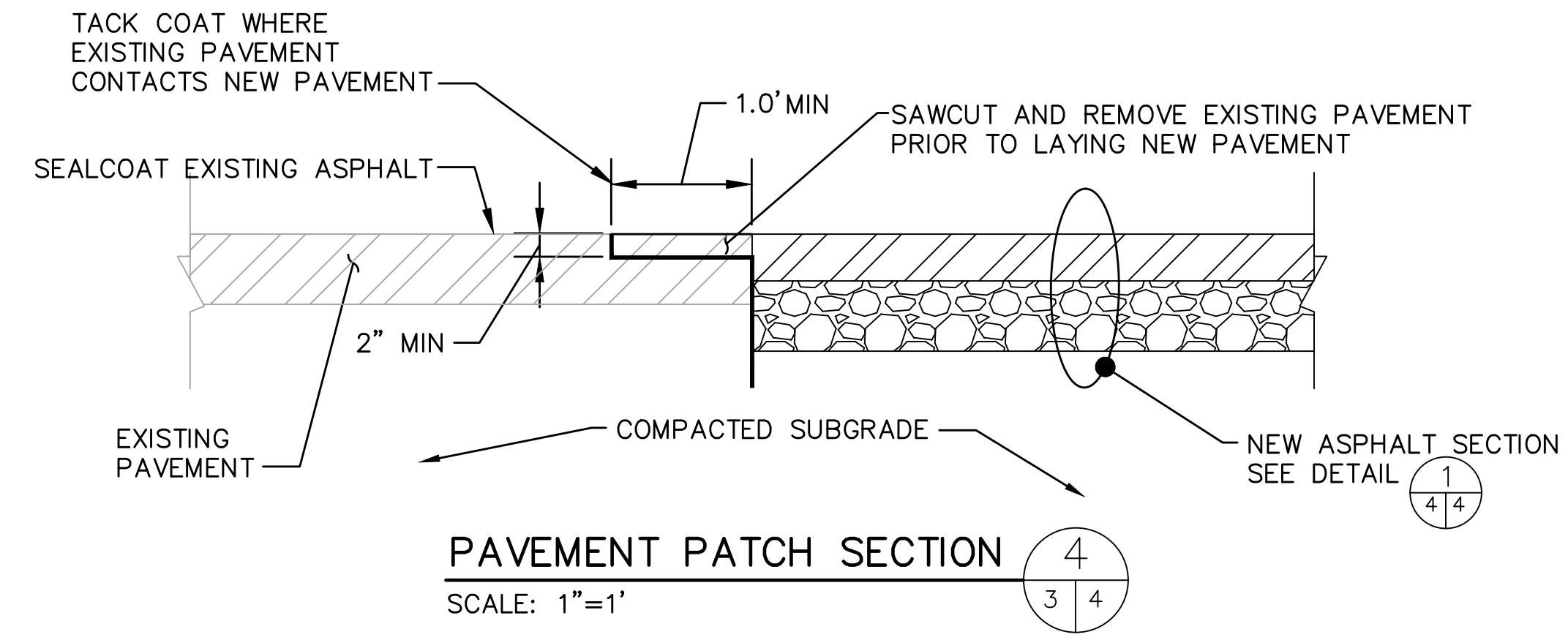

PAVEMENT PATCH SECTION
SCALE: 1"=1'

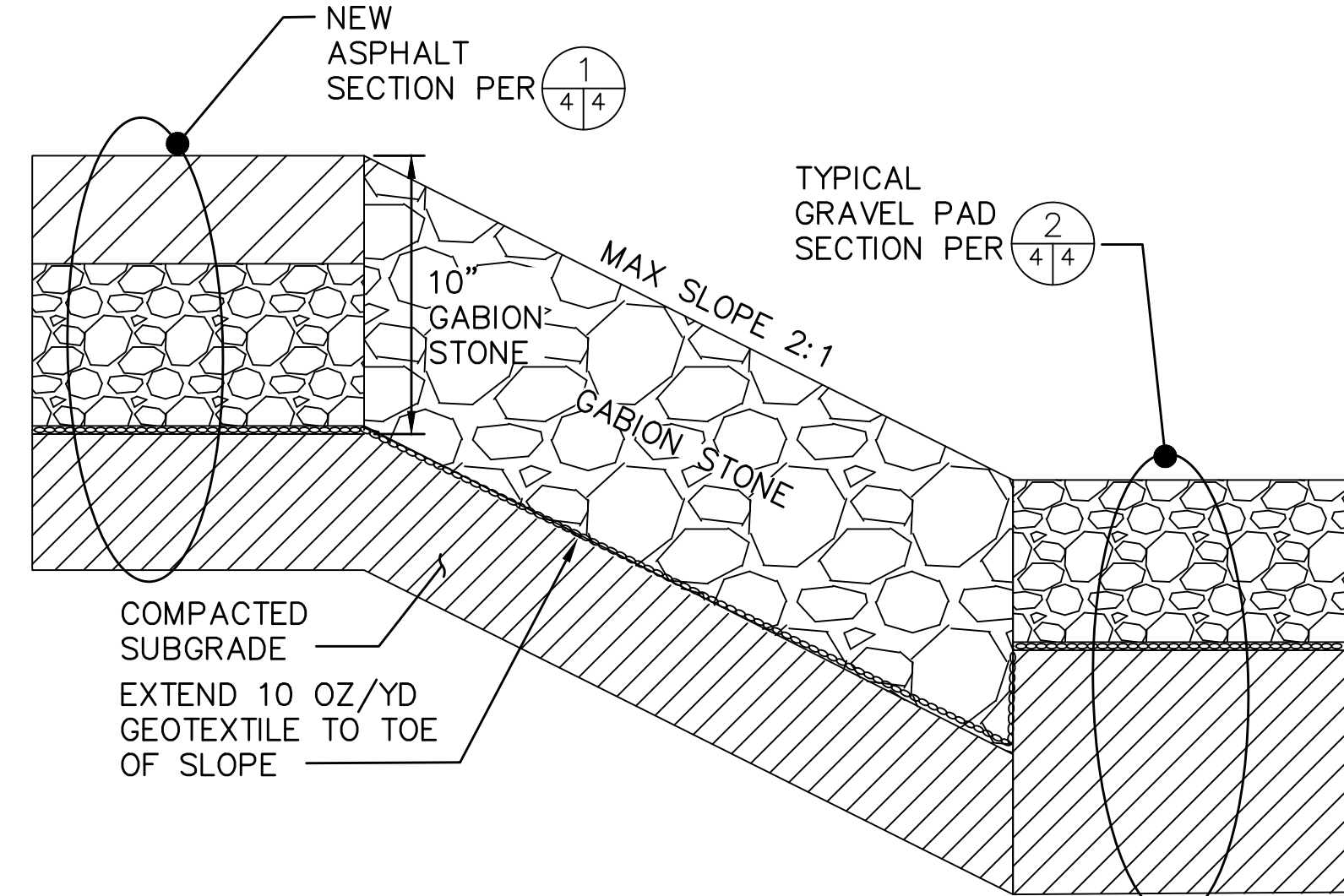

ASPHALT APRON DETAIL
NOT TO SCALE

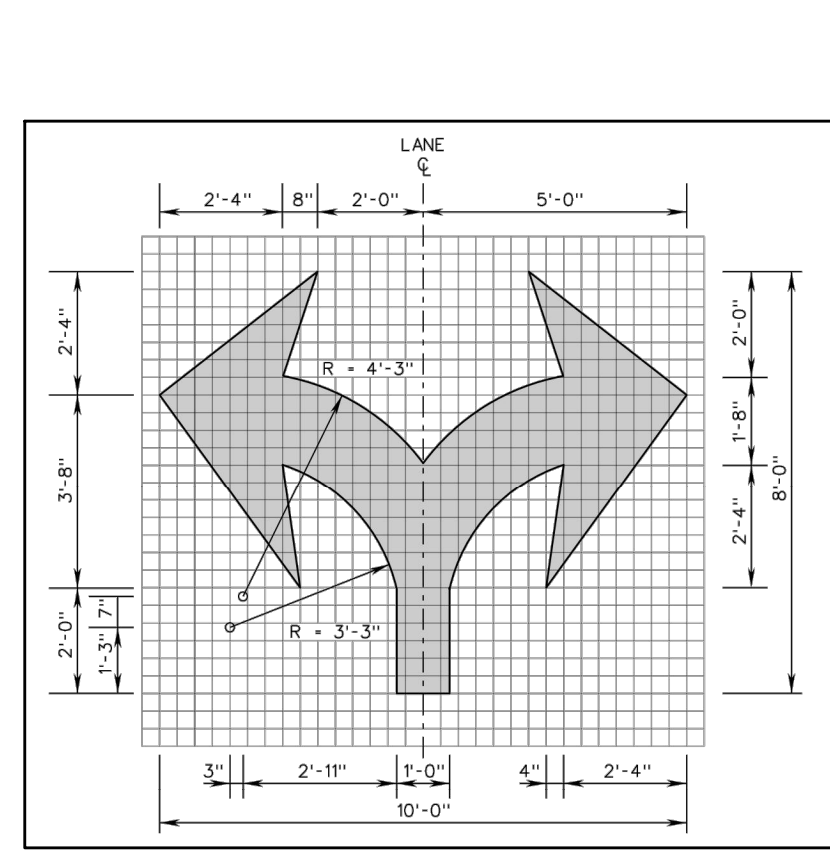

DOUBLE TURN ARROW
NOT TO SCALE

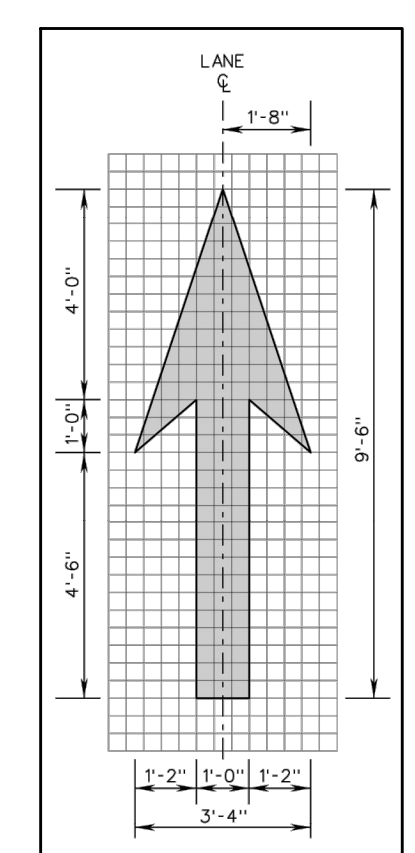

THRU ARROW
NOT TO SCALE

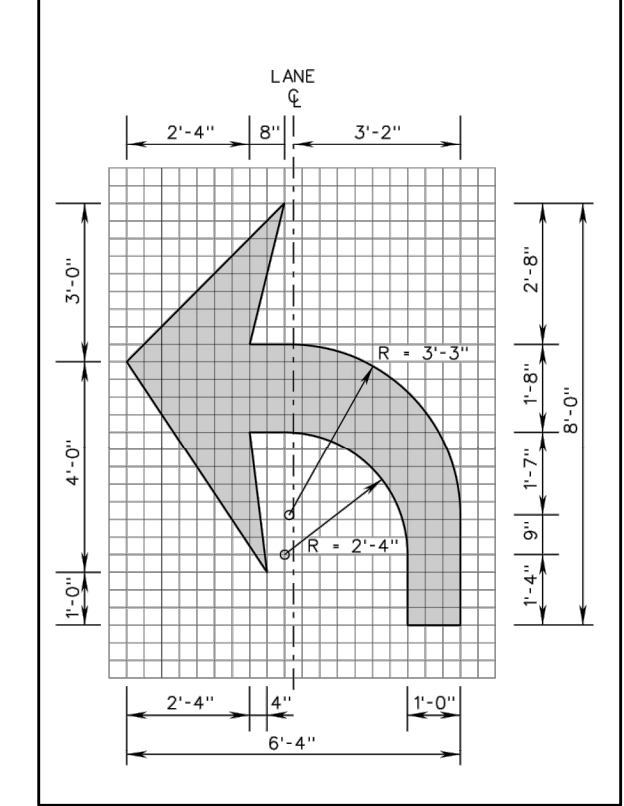

SINGLE TURN ARROW (LEFT OR RIGHT)
NOT TO SCALE

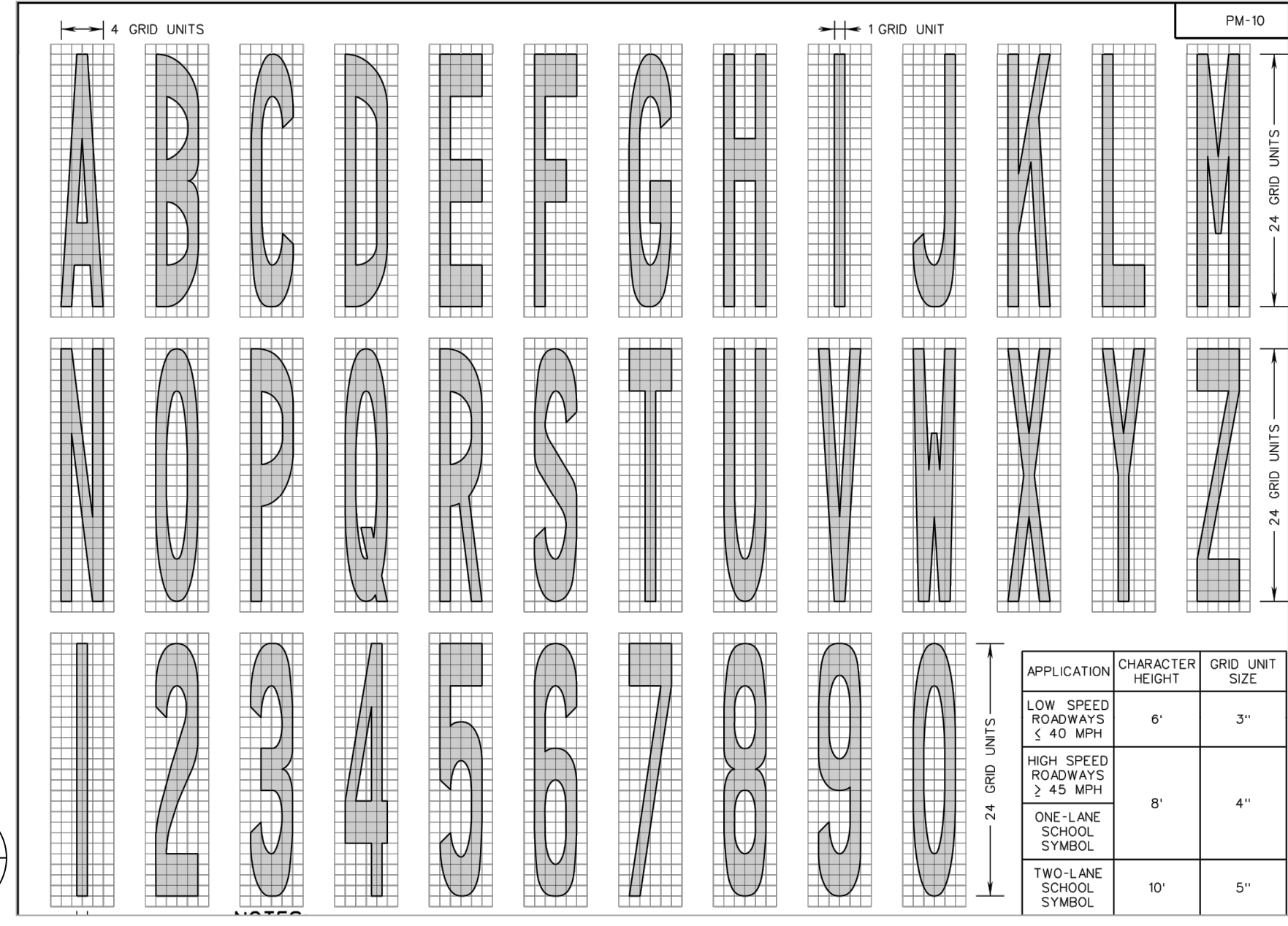

LETTERS AND NUMERALS DETAILS
NOT TO SCALE

GENERAL NOTES:

- FOR GENERAL BACKFILL AND FILL, USE GENERAL FILL. GENERAL FILL SHALL BE INORGANIC SOIL, THAT IS NOT EXCESSIVELY WET OR SATURATED, FREE OF STONE, ROCK OR GRAVEL LARGER THAN (3) INCHES IN ANY DIMENSION, AND FREE FROM DEBRIS, WASTE, FROZEN MATERIAL, VEGETATION, ORGANIC MATERIALS, ROOTS, AND OTHER DELETERIOUS MATTER. PLACE GENERAL FILL IN LAYERS NO MORE THAN 8" IN LOOSE DEPTH TO REQUIRED ELEVATIONS AND COMPACT BY HEAVY COMPACTION EQUIPMENT.
- COMPACTED SUB-GRADE BENEATH ALL PROPOSED ASPHALT, GRAVEL OR CONCRETE SURFACE TO BE PROOF-ROLLED AND COMPACTED BY APPROPRIATE HEAVY EQUIPMENT FOR AT LEAST 6 PASSES. IF PUMPING IS ENCOUNTERED EXCAVATE AND REMOVE THE UNDERLYING UNSUITABLE MATERIAL MINIMUM DEPTH OF 12 INCHES.
- ASPHALT CONCRETE PLACEMENT SHALL BE PLACED IN ACCORDANCE WITH VDOT 2016 ROAD AND BRIDGE SPECIFICATIONS SECTION 315.
- GRAVEL PAD VDOT 21B STONE MATERIAL SHALL BE IN ACCORDANCE WITH VDOT 2016 ROAD AND BRIDGE SPECIFICATIONS SECTION 207 SUBBASE AND AGGREGATE BASE MATERIAL.
- PROVIDE SHOE DRAWINGS FOR ALL SLIP-FORM, CAST IN PLACE AND PRECAST REINFORCED CONCRETE STRUCTURES, SLABS, AND EQUIPMENT PADS. SHOP DRAWING SHALL SHOW LOCATION, DIMENSIONS, AND ARRANGEMENT, AND INDICATE LOCATIONS OF EXPANSIONS, CONTRACTION, AND CONTROL JOINTS FOR CONCRETE SECTIONS FOR THE FOLLOWING: CONCRETE PLACEMENT, FORMWORK, REINFORCEMENT AND PLACEMENT, ACCESSORIES, EQUIPMENT ANCHOR BOLT TEMPLATE, JOINT FILLER MATERIALS (CONTROL AND ISOLATION JOINTS). PLACE ALL CONCRETE IN ACCORDANCE WITH ACI 301, ACI 318(ACI 318M) AND NOTIFY THE OWNER MINIMUM 24 HOURS PRIOR TO COMMENCEMENT OF OPERATIONS. ANCHOR GUIDE RAIL SYSTEM PER MANUFACTURER'S RECOMMENDATIONS.
- PAVEMENT MARKING DETAILS FROM VDOT 2016 ROAD AND BRIDGE STANDARD DETAIL PM-10 PAVEMENT WORD, SYMBOL, AND ARROW MARKINGS. AND VDOT SPECIFICATION REFERENCE 704.
- ANY AREAS DISTURBED BY CONSTRUCTION SHALL BE STABILIZED WITH PERMANENT SEEDING IMMEDIATELY FOLLOWING FINAL GRADING. SEEDING SHALL BE COMPLETED ACCORDING TO THE PERMANENT SEEDING CHART PROVIDED ON THIS SHEET, WHICH IS CONSISTENT WITH SITE SPECIFIC SEEDING MIXTURES FOR PIEDMONT AREA FROM THE VIRGINIA EROSION AND SEDIMENT CONTROL HANDBOOK.
- THE CONTRACTOR IS RESPONSIBLE FOR ALL VEGETATIVE AND STRUCTURAL EROSION AND SEDIMENT CONTROL PRACTICES WILL BE CONSTRUCTED CONSTRUCTED AND MAINTAINED ACCORDING TO MINIMUM STANDARDS AND SPECIFICATION OF THE CURRENT EDITION OF THE VIRGINIA EROSION AND SEDIMENT CONTROL HANDBOOK. THE CONTRACTOR IS RESPONSIBLE FOR PROTECTING ANY SEDIMENT LEAVING THE SITE, WEATHER THE TRACKING OF VEHICLES, UN-CONTROLLED STORMWATER RUNOFF, DUST DURING CONSTRUCTION ACTIVITIES, EFFLUENT FROM DE-WATERING OPERATIONS OR ANY OTHER CONSTRUCTION ACTIVITIES THAT ARE ASSOCIATED WITH LAND DISTURBING ACTIVITY.

PERMANENT SEEDING CHART	
SPECIES	RATE** (lbs/acre)
KENTUCKY 31 FESCUE	108
RED TOP GRASS	2
SEASONAL NURSE CROP*	20
CROWN VETCH #	20

* USE SEASONAL NURSE CROP IN ACCORDANCE WITH SEEDING DATES AS STATED BELOW:
 FEBRUARY THRU APRIL: ANNUAL RYE
 MAY 1 THRU AUGUST: FOXTAIL MILLET
 SEPTEMBER THRU NOVEMBER 15: ANNUAL RYE
 NOVEMBER 16 THRU JANUARY: WINTER RYE

** TOTAL RATE IS 150 LBS/ACRE AS SHOWN.

IF FLAT PEA IS USED IN LIEU OF CROWN VETCH, THEN INCREASE RATE FROM 20-30 LBS/ACRE.

Unit	Measurement
Compressive Strength (7 day)	3,000 psi (21 MPa)
Compressive Strength (28 day)	4,000 psi (32 MPa), unless otherwise noted on Drawings.
Water/Cement Ratio (maximum)	0.45 by weight (mass)
Aggregate Size (maximum)	1.5 inch
Air Entrained	4.5 percent plus/minus 2 percent
Admixture	As approved by the OWNER
Fly Ash Content	Maximum 25 percent of cement content
Slump	3 inches plus or minus 1 inch

CONCRETE MIX DESIGN

M:\PROJECTS\02218209.03 PITTSYLVANIA COUNTY\DRAWINGS

DATE	REVISION	NO.

DETAILS-1 AND GENERAL NOTES
TUNSTALL-BROSVILLE (HWY 622) COLLECTION CENTER

PITTSYLVANIA COUNTY
1 CENTER STREET
CHATHAM, VA 24531

SCS ENGINEERS
 STEARNS, CONRAD AND SCHMIDT
 CONSULTING ENGINEERS, INC.
 2877 GUARDIAN LANE, VIRGINIA BEACH, VA 23462
 PH. (757) 466-3361 FAX: (757) 267-6369

CADD FILE: SHT-04_DETAILS
 DATE: JUNE 2019
 SCALE: AS SHOWN
 DRAWING NO.

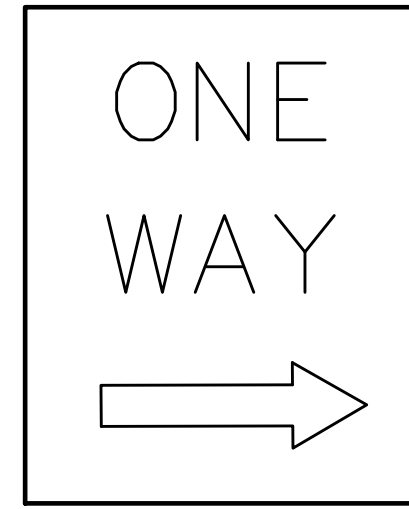

R10A

ONE-WAY SIGN DETAIL

1
3 5

NOT TO SCALE

NOTES:

1. LETTER COLOR - BLACK.
2. BACKGROUND COLOR - WHITE RETRO-REFLECTIVE.
3. MOUNT ON FENCE AT ENTRANCE.

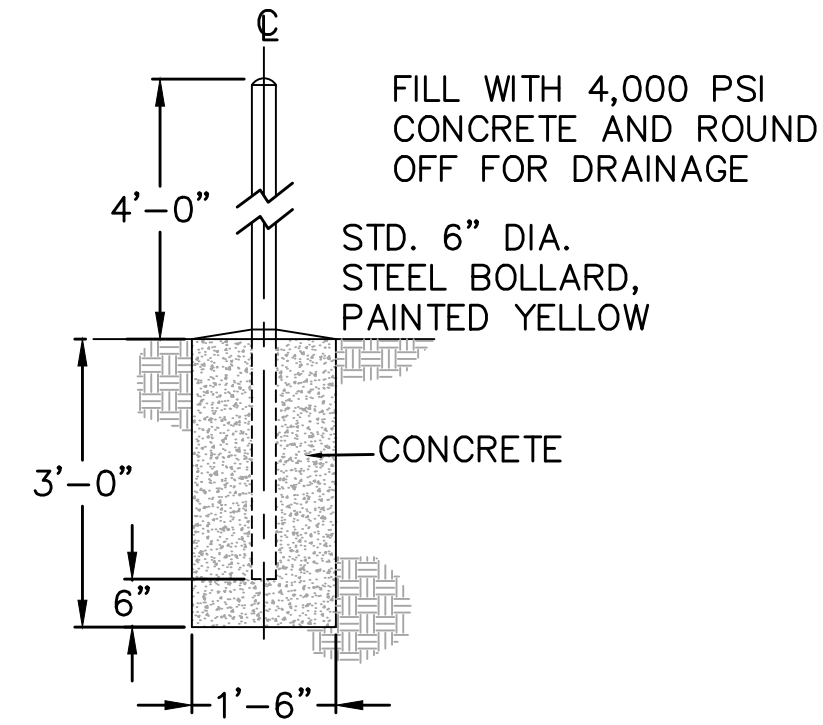

BOLLARD DETAIL

2
3 5

NOT TO SCALE

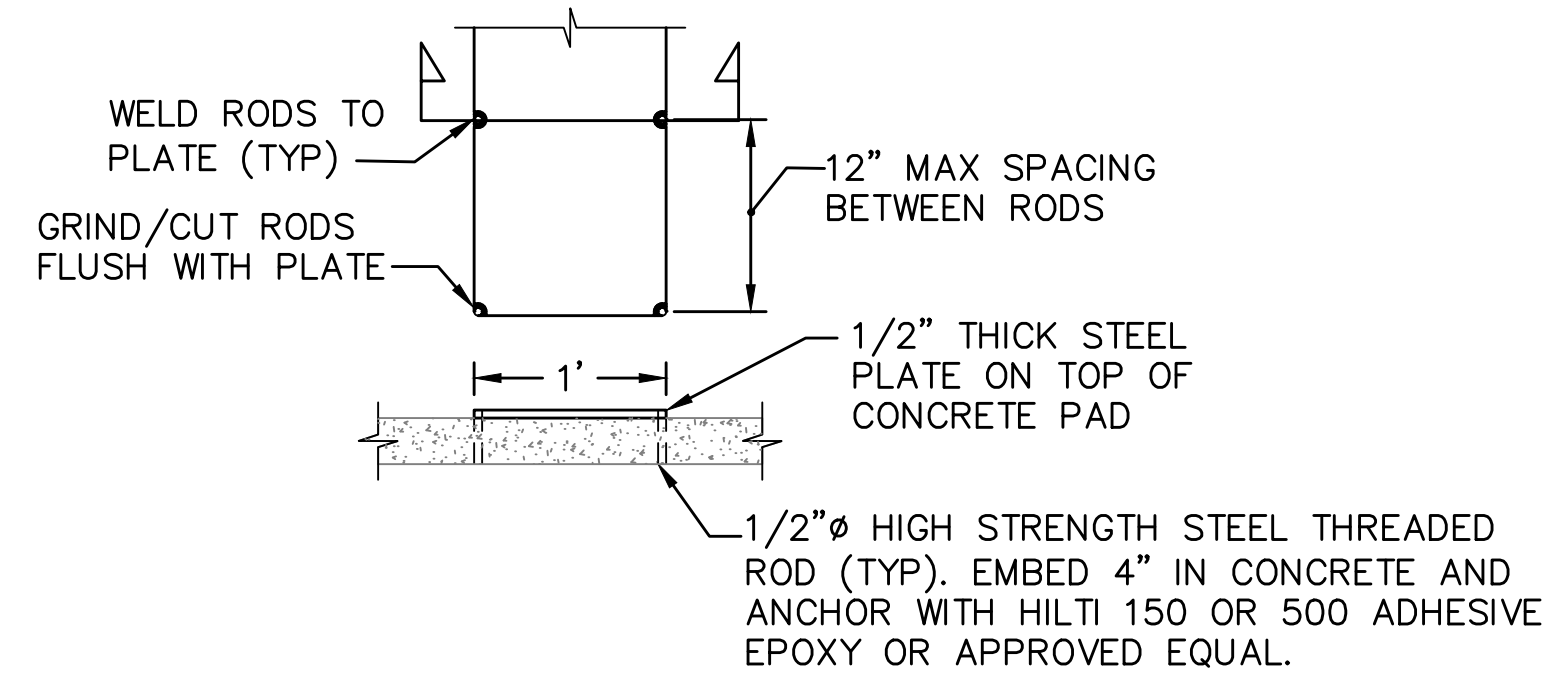

STEEL PLATE - DETAIL

3
3 5

NOT TO SCALE

NOTES:

1. PREFABRICATE SLOTS AT PLATE EDGES TO ACCOMMODATE RODS.
2. ENSURE SPACING OF PLATES IS COMPATIBLE WITH RECYCLABLE'S COLLECTION ROLL-OFF CONTAINERS INTENDED FOR USE ON PADS.

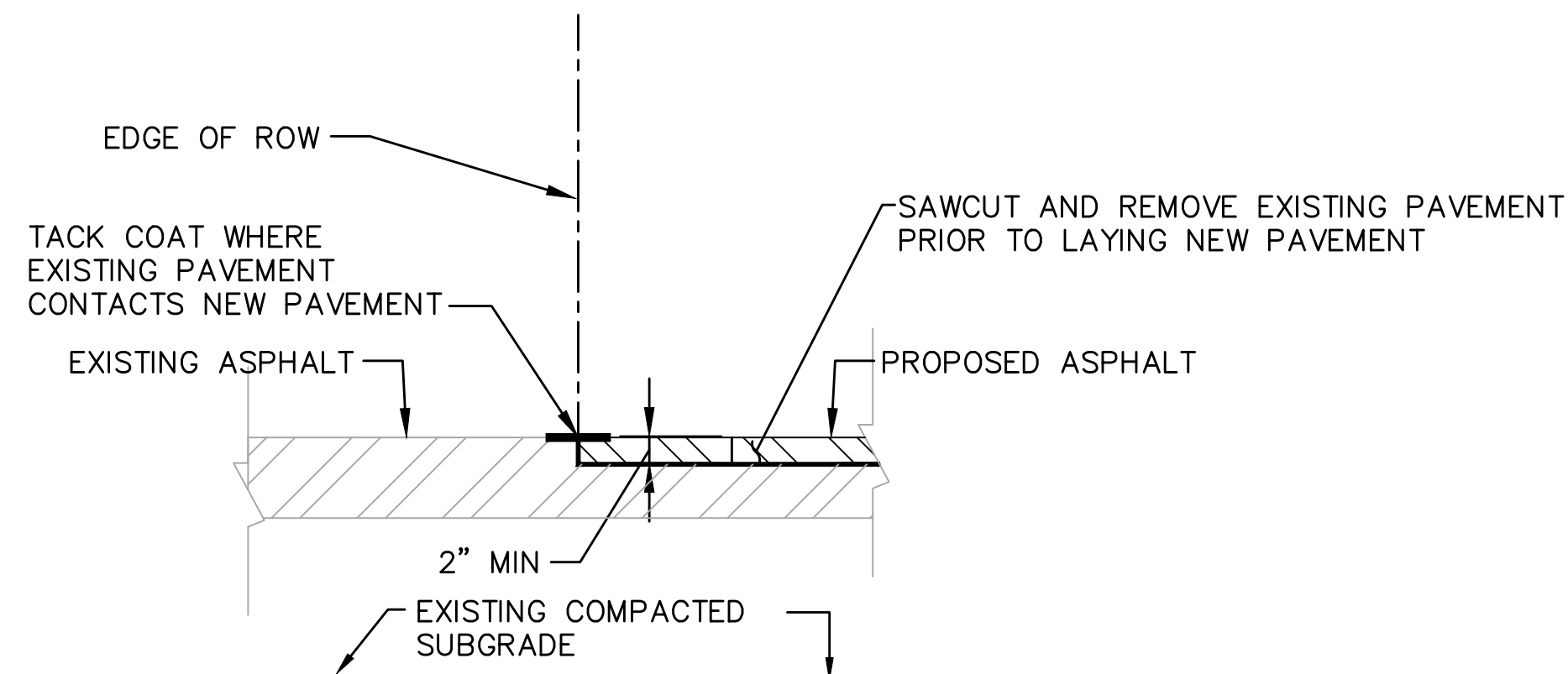

MILLED AND RE-PAVE DETAIL

4
3 5

SCALE: 1"=1'

NOTES:

1. CONTRACTOR TO MILL AND RE-PAVE EXISTING SITE ENTRANCE TO THE EXTENTS SHOWN ON DRAWING NO. 3 SITE PLAN.
2. CONTRACTOR TO AVOID DISTURBING BURIED TELEPHONE LINE AN ANY ADDITIONAL UTILITIES IN AREA.
3. CONTRACTOR TO ABIDE BY VDOT REGULATIONS AND THE VIRGINIA WORK AREA PROTECTION MANUAL WHILE PERFORMING WORK WITHIN THE VDOT RIGHT OF WAY, PARTICULARLY DURING PERFORMANCE OF SHOULDER/LANE CLOSURE ACTIVITIES ALONG CASCADE ROAD.

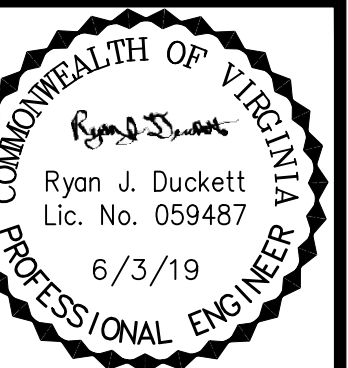

DATE	6/25/19
REVISION	
ADDENDUM #1	
NO.	

DETAILS - 2 - REVISED
PROJECT TITLE
**TUNSTALL-BROSVILLE (HWY 622)
COLLECTION CENTER**

CLIENT
**PITTSYLVANIA COUNTY
1 CENTER STREET
CHATHAM, VA 24531**

SCS ENGINEERS
STEARNS, CONRAD AND SCHMIDT
CONSULTING ENGINEERS, INC.
2877 GUARDIAN LANE, VIRGINIA BEACH, VA 23462
PH. (757) 466-3361 FAX. (757) 257-6349

PROJ. NO. 02218209.03
DATE: 02/21/2019
CHK. BY: NTJ
APP. BY: RSD

DWG. BY: NTJ
CHK. BY: CSW

G/A BY: NTJ
APP. BY: RSD

CADD FILE:
SHT-04_DETAILS

DATE:
JUNE 2019

SCALE:
AS SHOWN

DRAWING NO.
5 of 5