

**SITE DATA**

**INCLUDED PARCELS:**

SEE APPLICATION PACKAGE

**MAXIMUM FLOOR AREA RATIO:**  
ALLOWABLE DENSITY  
PROPOSED DENSITY

NOT REGULATED  
N/A

**OPEN SPACE:**

TOTAL SITE AREA  
OPEN SPACE REQUIRED  
OPEN SPACE PROVIDED

760± ACRES  
10%  
65%

**SITE REQUIREMENTS:**

FRONT SETBACK (MBL)  
SIDE SETBACK (MBL)  
REAR SETBACK (MBL)  
MAXIMUM HEIGHT

75' FEET  
75' FEET  
75' FEET  
80', 120' FEET IN INDUSTRIAL PARKS

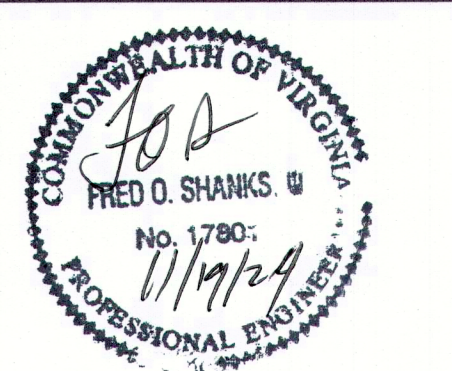
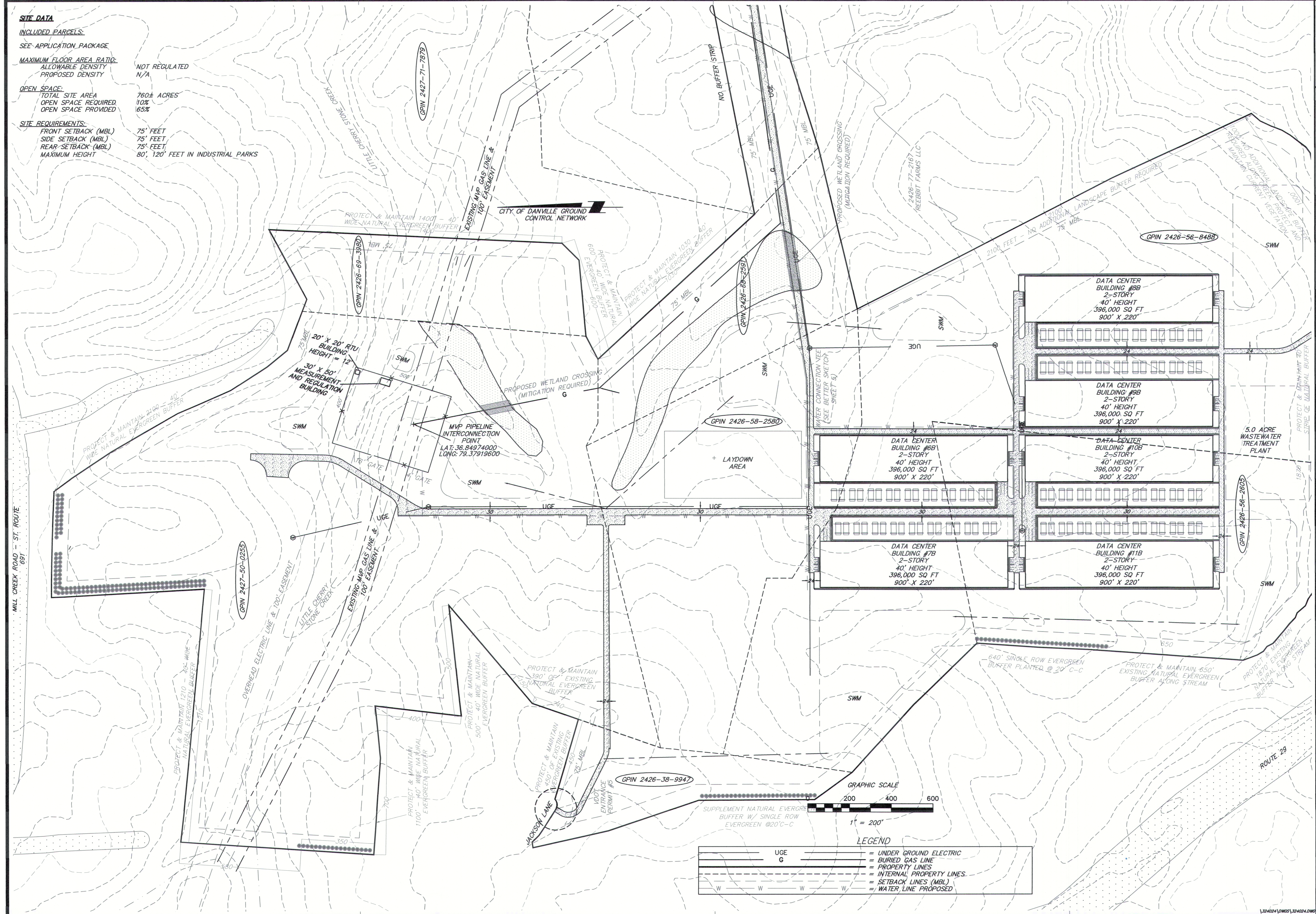

**SHANKS ASSOCIATES, P.C. - ENGINEERS - SURVEYORS - PLANNERS**  
 507 LOYAL STREET, DANVILLE VIRGINIA 24541  
 TEL: (434) 797-5446  
 foshanks@outlook.com

DATE:	11/19/24
DRAWN BY:	MELTON
DESIGNED BY:	F.O.S.
CHECKED BY:	
SCALE:	1" = 200'
CALC. CHK:	
MVP Tap & Interconnection and Data Center	
Conceptual Plan Balico Technology Campus Phase 1	
SHEET NUMBER	5 OF 5
JOB NUMBER	324024

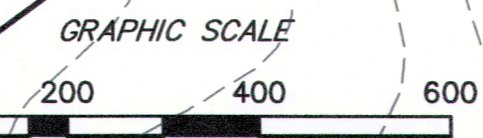

**LEGEND**

UGE	= UNDER GROUND ELECTRIC
G	= BURIED GAS LINE
---	= PROPERTY LINES
- - - -	= INTERNAL PROPERTY LINES
---	= SETBACK LINES (MBL)
---	= WATER LINE PROPOSED